

Description	Product Code	Weight (Lbs.)
<b>Bases</b>		
72" x 72" x 66" ID Custom Base	727266B	14,400
<b>Risers</b>		
72" x 72" x 6" ID Riser	72726R	975
72" x 72" x 12" ID Riser	727212R	1,950
72" x 72" x 24" ID Riser	727224R	3,900
72" x 72" x 36" ID Riser	727236R	5,850
<b>Slab Top</b>		
72" x 72" ID Slab Top x 6" Tall with 48" x 48" Opening	72726ST48	2,480
<b>E Top</b>		
48" x 48" x 18" E Top	484818E	1,600
<b>Cast Iron</b>		
32" Ring	32R	75
32" Cover	32C	175

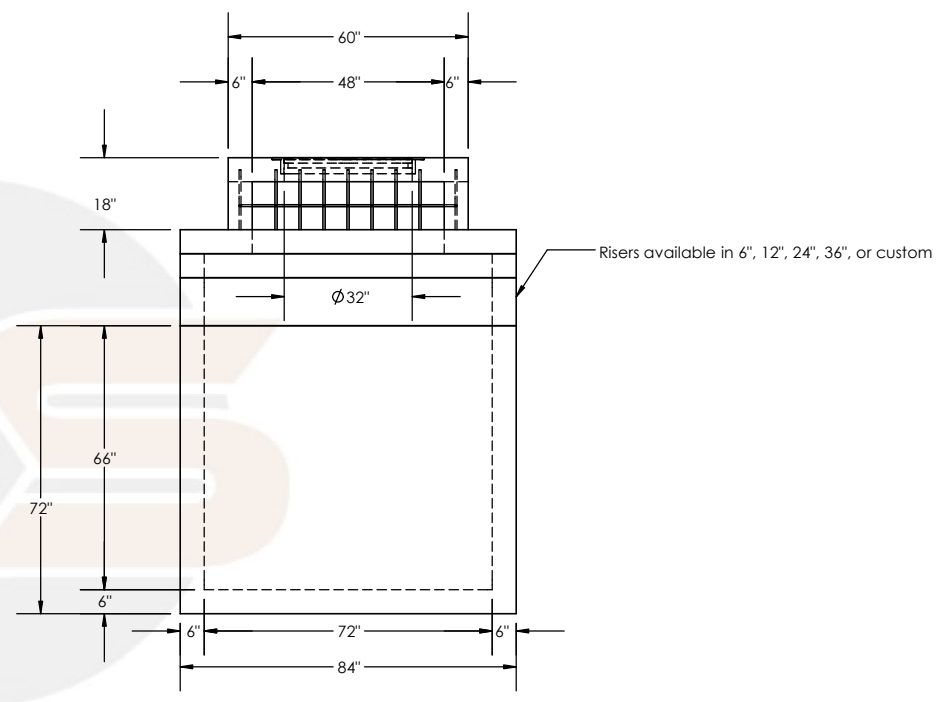

**Side View**  
Scale: 1/4" = 1'

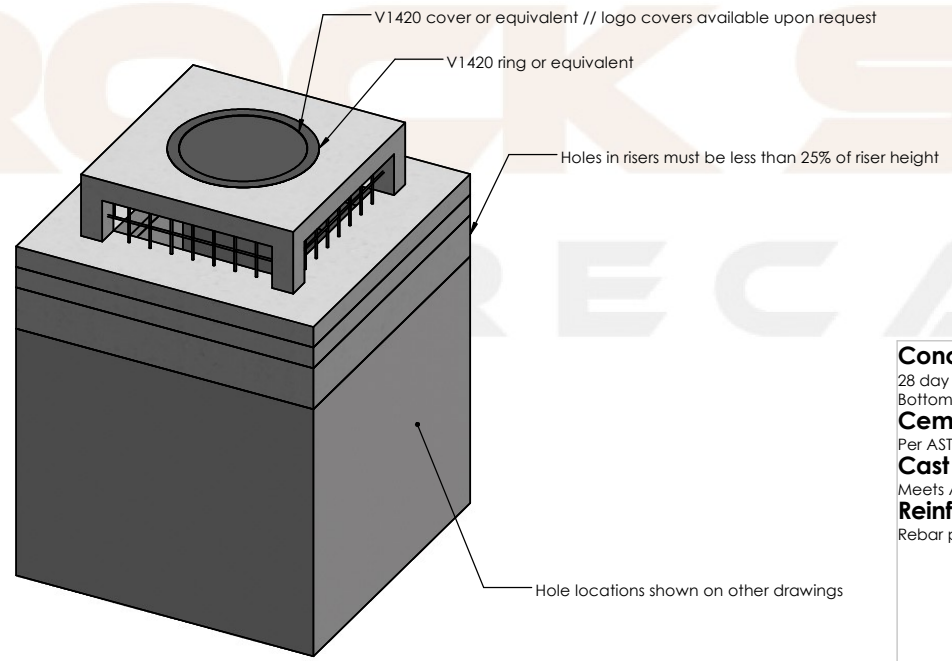

**Isometric View**  
Scale: 1/4" = 1'

**Concrete**  
28 day compressive strength of 4,500 PSI  
Bottoms to be monolithic at floor and at first stage of wall

**Cement**  
Per ASTM C150: Type I

**Cast Iron**  
Meets ASTM A48 and CL35B Standards

**Reinforcement**  
Rebar per ASTM A615 Grade 60

**Rock Solid Precast, L.P.**

11393 Sleepy Hollow Road PO Box 8066  
Conroe, TX 77385 The Woodlands, TX 77387  
(281) 364-7474

TITLE  
72" x 72" Type E Hole Specific  
Submittal Drawing

**PROPRIETARY AND CONFIDENTIAL**  
THE INFORMATION CONTAINED IN THIS DRAWING IS THE SOLE PROPERTY OF ROCK SOLID PRECAST, LP. ANY REPRODUCTION IN PART OR AS A WHOLE WITHOUT THE WRITTEN PERMISSION OF ROCK SOLID PRECAST, LP IS PROHIBITED.

DWG. NO. 72EHS Submittal Drawing  
DRAWN CHECKED WEIGHT  
MKK